

MOBILE CREDENTIAL READER ENROLLMENT (TS-RU20-PB & TS-RU20-MB)



1) ENABLE MOBILE READER INSTALLER

OPTION 1

Connected to 1-Door Controller (TS-WU-1DR)



- Open the TrueSecure ADMIN app, and login to your account
- Select “Account” in the lower right of the Home page
- Select “Enable Mobile Reader Installer”
- Select “Create” - this sends an email for use in Step 2

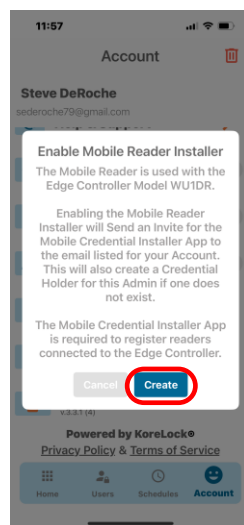
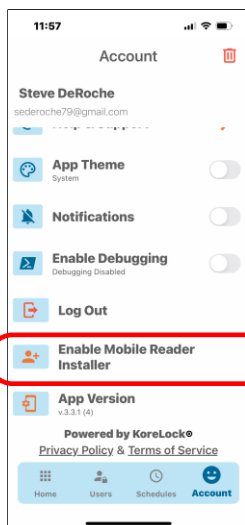

OPTION 2

Connected to Wired Mercury Access Control Panel

- Log into your Cloud Access Control account
- Select “Integrations” in menu options
- Select the “Mobile Credentials for Wired Access Panels” icon



- Select “Add Installer”
- Enter email address and click “Add New Installer” - this sends an email for use in Step 2

2. OPEN EMAIL AND MOBILE APP

- Open email from titled “Your Credential is Ready”, follow instructions:

STEP 1: Download and Open the app

STEP 2: Return to the email and select “[On your mobile device, tap here to import your credential.](#)”

For more information visit: TrueSecurePro.com

MOBILE CREDENTIAL READER ENROLLMENT (TS-RU20-PB & TS-RU20-MB)



3. ENROLL READER

- Select the “>” arrow next to your account in the TrueSecure KEY app
- Select the “+” symbol in the upper right corner of the page
- Supply power to reader
- **IMPORTANT TS-RU20-MB ONLY: Using the included jumper wire, short the black terminal with white wires for 2 seconds (see picture) to enable reader enrollment mode**
- Touch your mobile device to the reader, device will begin enrollment process
- Name the reader and click “Done”
- Confirm “Device Enrolled” and select “OK”

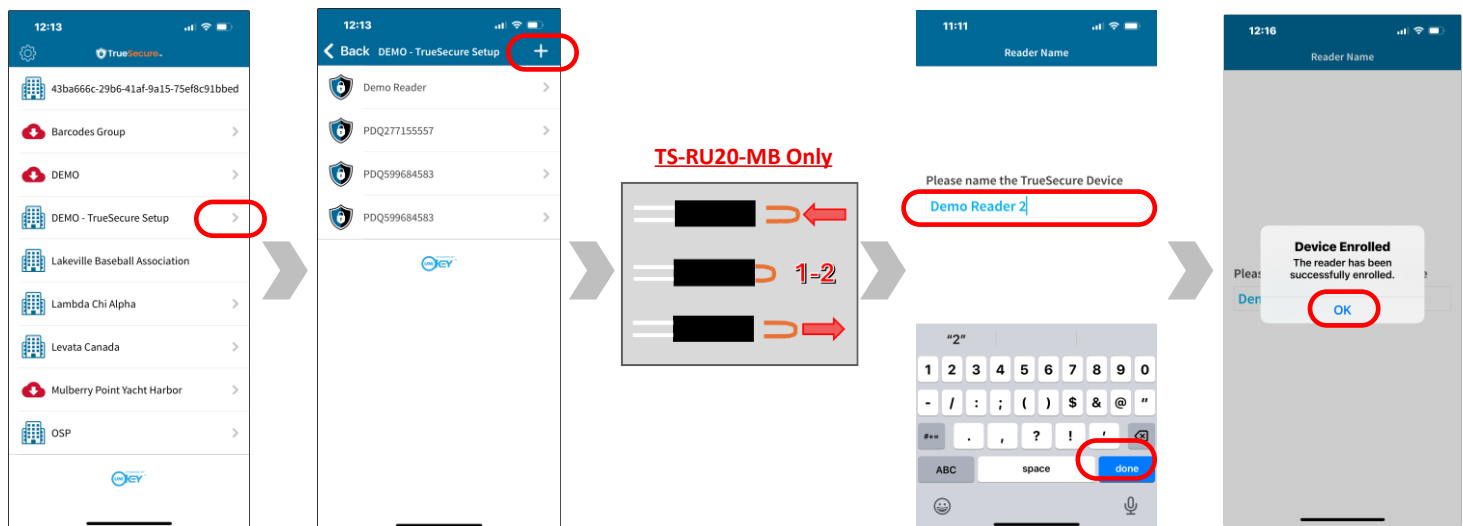

TROUBLE SHOOTING: READER FAILS TO ENROLL

If the reader fails to enroll or a “Reader Already Enrolled” message appears, reset the reader:

TS-RU20-PB

- Power the reader
- Press and hold the small gray reset button on the back until the reader beeps
- The reader will reboot and is ready to enroll when a solid yellow ring is displayed
- Return to Step 3 to enroll the reader

TS-RU20MB

- Remove power from the reader
- Connect the jumper wire to the black connector with white wires as pictured above
- Power the reader and disconnect the jumper wire 10 seconds after reader beeping stops
- Wait 2 minutes while the reader is rebooting (red light will be on but no alert follows reboot)
- Return to Step 3 to enroll the reader