

INSTALLATION INSTRUCTION

GRADE 2 CYLINDRICAL LOCK (TS-WPG2)

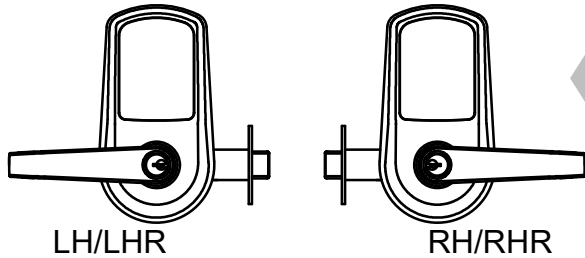

1. HANDING CHANGE INSTRUCTIONS GRADE 2 LEVER LOCK (TS-WPG2)

- Before removing existing hardware, ensure handing of new lock is correct for door opening.
- If handing of lock is not correct for opening, please visit TrueSecurePro.com for "HANDING CHANGE INSTRUCTIONS GRADE 2 CYLINDRICAL LOCK."

2. PREPARE DOOR & INSTALL LATCH

- Prepare door according to template.
- Install latch, radius toward door frame
- Secure with (2) small combo screws.

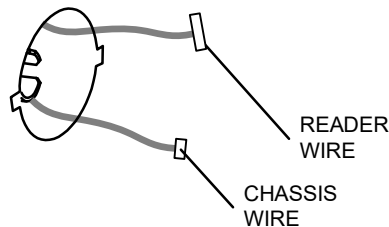
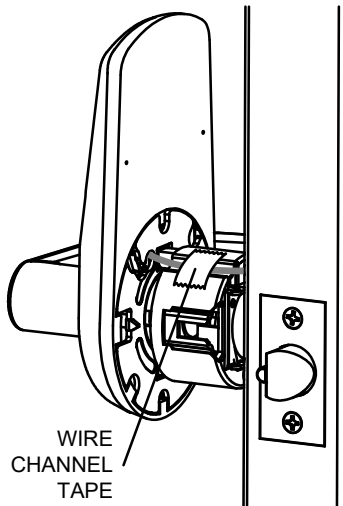
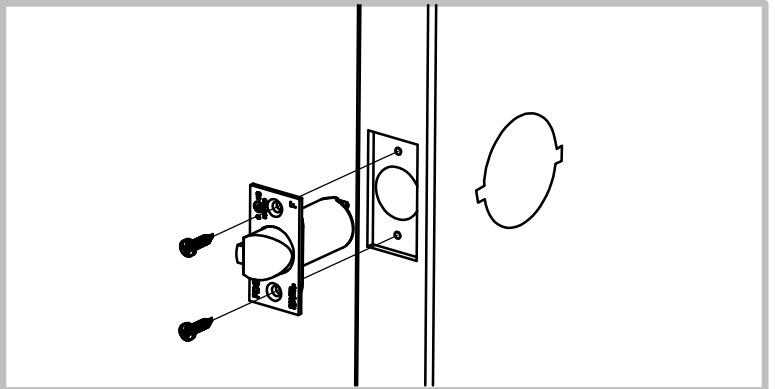

3. INSTALL OUTSIDE TRIM / CHASSIS ASSEMBLY

- Install escutcheon/chassis assembly from outside of door – feeding wires through chassis hole in door.
- Verify wire is secured on chassis channel under tape

4. INSTALL INSIDE MOUNTING PLATE

- Install inside mounting plate and secure with (2) flat head screws.

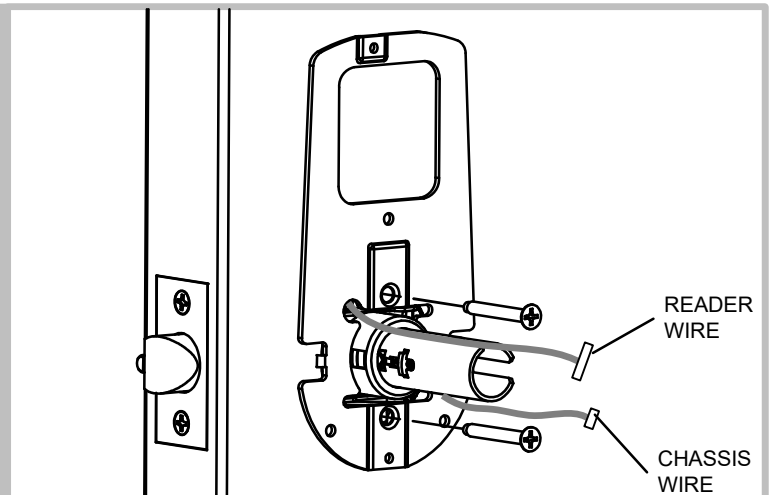

INSTALLATION INSTRUCTION

GRADE 2 CYLINDRICAL LOCK (TS-WPG2)



5. CONNECT READER AND INSTALL INSIDE TRIM

- Plug reader wire and chassis wire into sockets on control board on back of escutcheon, install escutcheon onto door. Be careful not to pinch wires.
- Secure escutcheon with (2) short pan head screws.
- Install batteries and battery cover with long pan head screw.
- Install lever ring and inside lever – push until lever retaining clip clicks into place.

