

Installation
Template for
MRS Sectional
Mortise Locksets

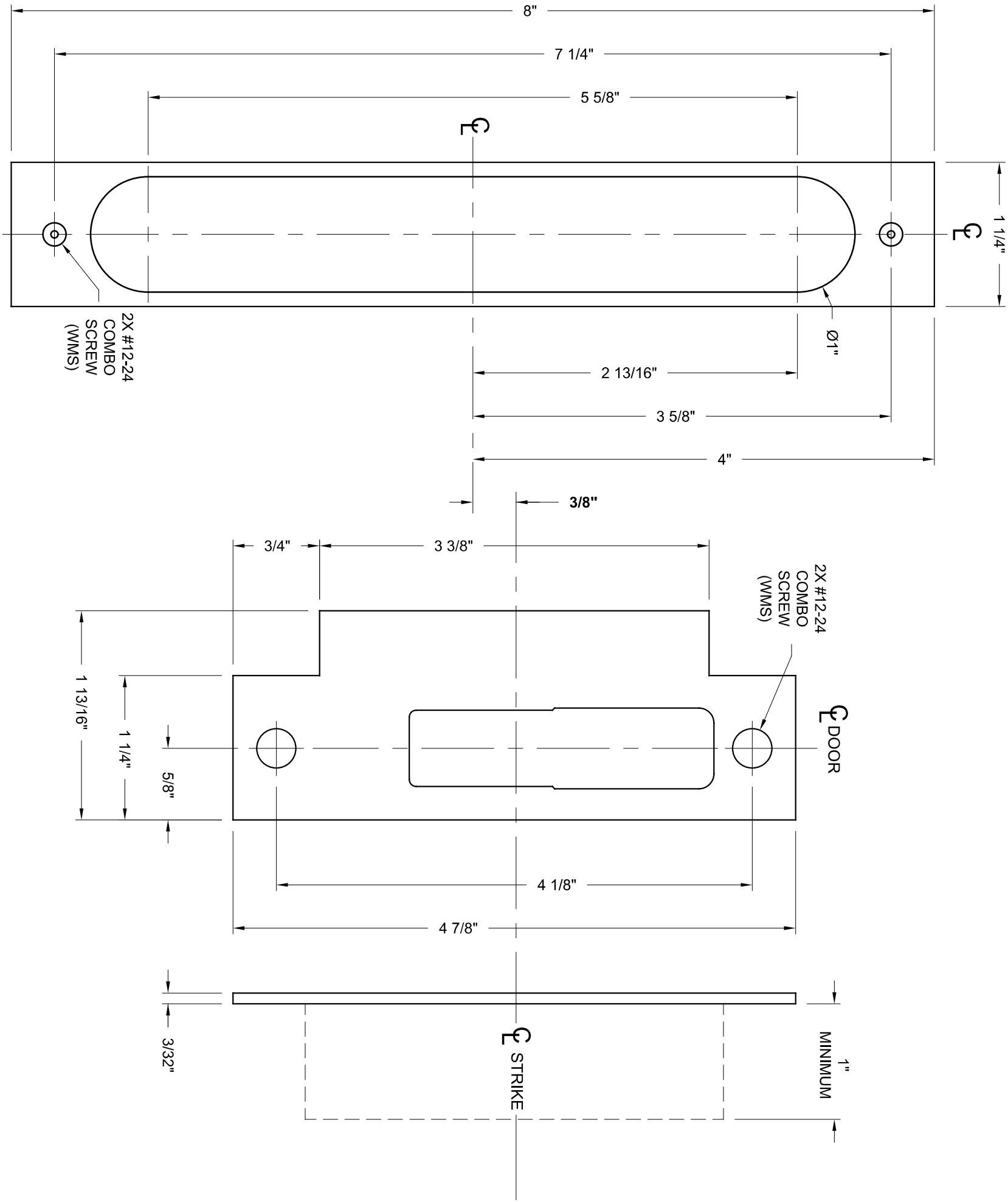

ANSI STANDARD:
MRS SERIES MORTISE LOCKS ARE INSTALLED
FOLLOWING THE DOOR AND FRAME REQUIREMENTS
FOUND IN ANSI/BHMA A156.13.

DOORS:
REINFORCEMENT IS REQUIRED PER ANSI A115.1.

DOOR THICKNESS:
STANDARD DOOR THICKNESS IS 1-3/4".
CONSULT FACTORY FOR OTHER DOOR SIZES.

SILENCERS AND WEATHER STRIPPING:
PROVISIONS MUST BE MADE TO ALLOW PROPER DOOR
CLOSURE WHEN USING DOOR SILENCERS, WEATHER
STRIPPING OR SOUND PROOFING.

Installation
Template for
MRS Sectional
Mortise Locksets

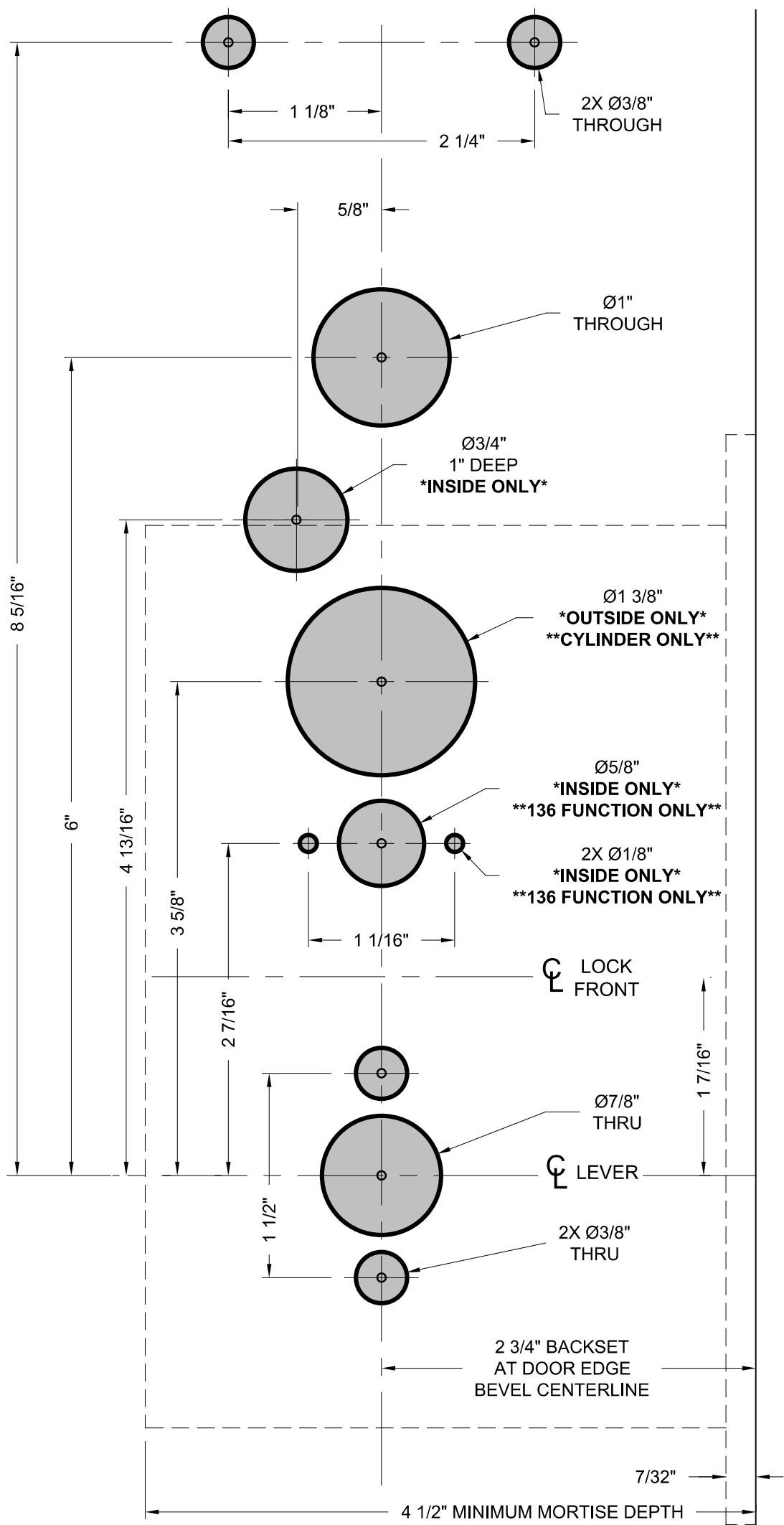

Installation

Template for

MRS Sectional

Mortise Locksets

ANSI STANDARD:
MRS SERIES MORTISE LOCKS ARE INSTALLED
FOLLOWING THE DOOR AND FRAME REQUIREMENTS
FOUND IN ANSI/BHMA A156.13.

DOORS:
REINFORCEMENT IS REQUIRED PER ANSI A115.1.

DOOR THICKNESS:
STANDARD DOOR THICKNESS IS 1-3/4".
CONSULT FACTORY FOR OTHER DOOR SIZES.

SILENCERS AND WEATHER STRIPPING:
PROVISIONS MUST BE MADE TO ALLOW PROPER DOOR
CLOSURE WHEN USING DOOR SILENCERS, WEATHER
STRIPPING OR SOUND PROOFING.

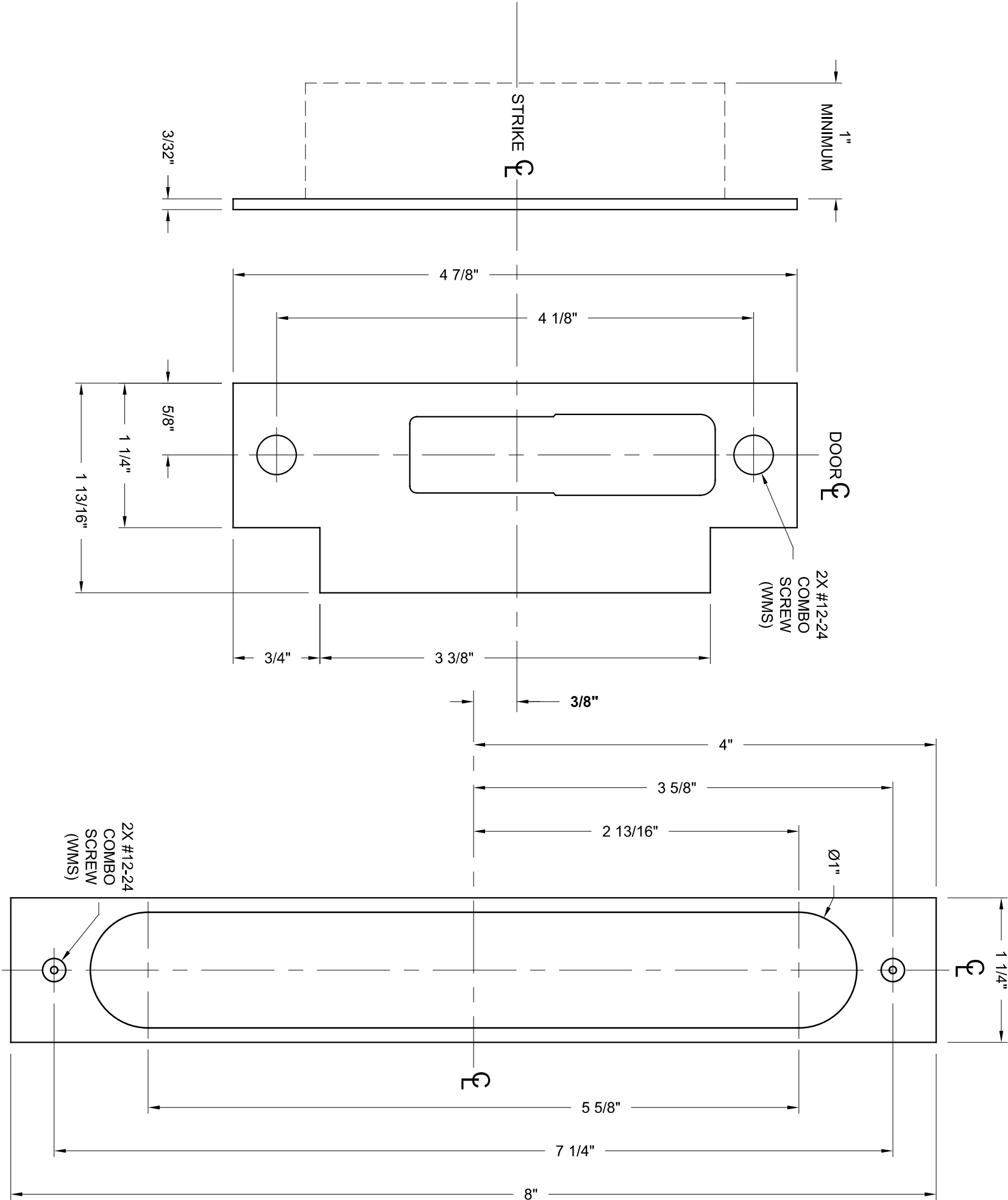

Installation
Template for
MRS Sectional
Mortise Locksets

